

## NEW Location for QEW Toronto-bound Off-Ramp to Glendale Ave and Lane Shifts on Glendale Ave just South of York Rd

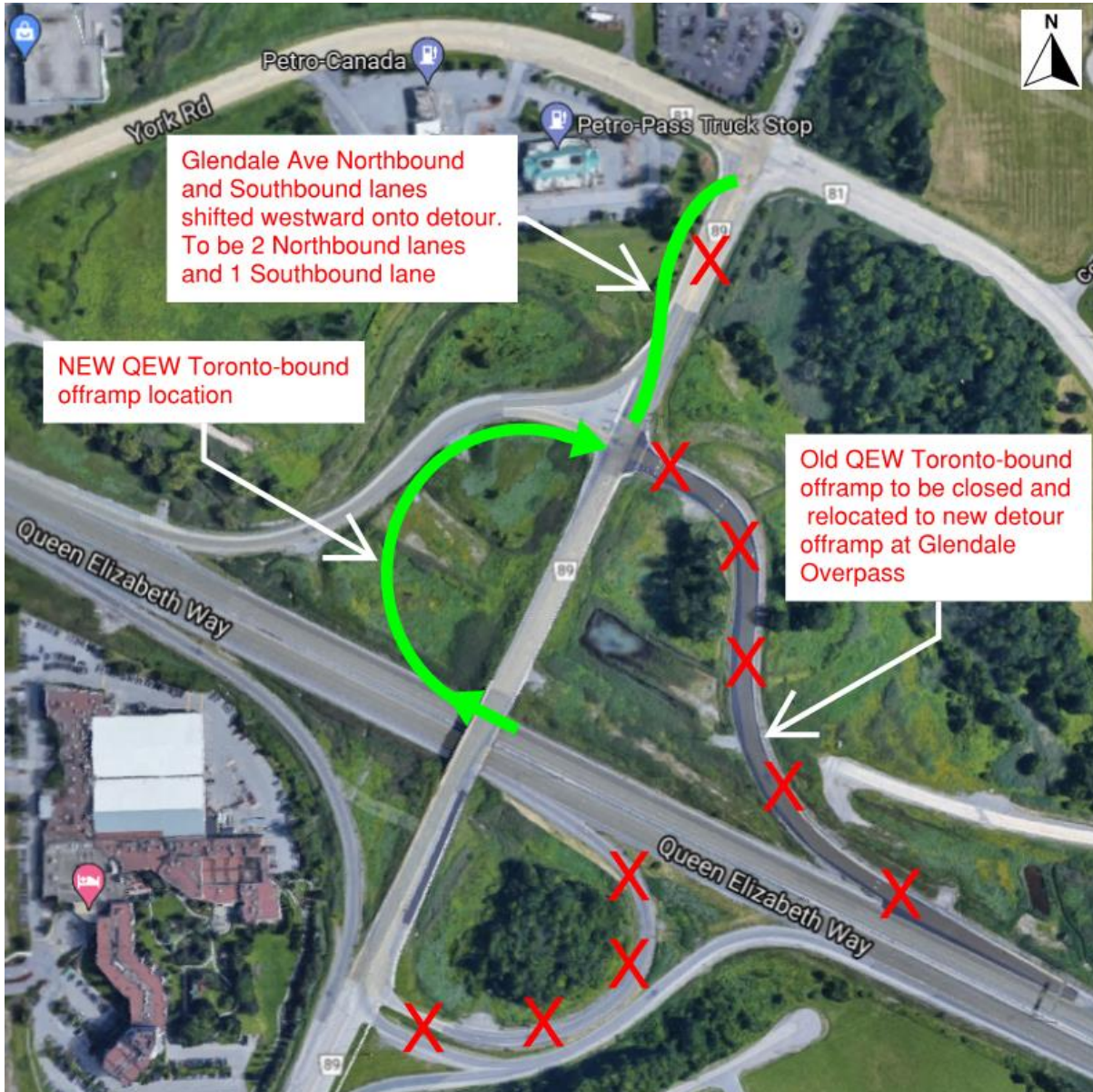

**Figure 1: Stage 3 traffic changes shown by green detour lines. Closed roadways/ramps shown by Red X's.**

### Construction Impacts:

- New location of QEW Toronto-bound offramp to Glendale Ave located just past Glendale overpass, old ramp to be closed (see Figure 1).
- Glendale Ave lanes shifted westward onto detour between QEW Toronto-bound ramp terminal and York Rd



# Construction Notice Update No. 007

QEW / Glendale Avenue Interchange Reconstruction,  
Design-Build Project



A COLAS COMPANY MORRISON HERSHFIELD

---

## Timing:

- The new QEW Toronto-bound offramp to Glendale Ave detour is expected to open and be operational on Tuesday November 30th, 2021, at which point the old offramp location will be closed (date is weather dependent and may change slightly).
- The Glendale Ave lanes will be shifted westward onto detour between QEW Toronto-bound ramp terminal and York Rd as of Tuesday November 30th, 2021

## For More Information:

Stay up to date on the project by visiting our website at <http://qew-glendale-interchange.ca/>

Or contact us at: [GlendaleDBTeam@morrisonhershfield.com](mailto:GlendaleDBTeam@morrisonhershfield.com)