

## Glendale Avenue Underpass - Precast Concrete Girder Erection

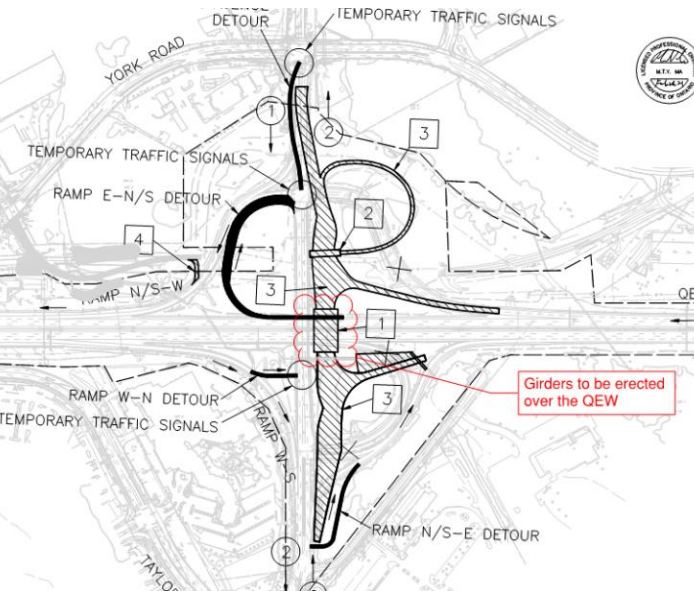

**Figure 1: Plan Location for Precast Concrete Girder Erection and Typical Crane Erection**

### Timing:

- Precast concrete girder erection is expected to take place on the nights of Wednesday and Thursday March 23/24, 2022 weather permitting

### Construction Impacts:

- Precast concrete girder erection will take place during nightly lane closures on the QEW between the hours of 7:00 pm to 5:00 am
- Rolling closures with the assistance of Ontario Provincial Police (OPP) will be required to safely install the precast concrete girders
- Glendale Avenue Northbound will be reduced to 1 lane South of the QEW during the day on Wednesday and Thursday March 23/24, 2022 for staging of precast concrete girders prior to nightly operations

### For More Information:

Stay up to date on the project by visiting our website at <http://qew-glendale-interchange.ca/>

Or contact us at: [GlendaleDBTeam@morrisonhershfield.com](mailto:GlendaleDBTeam@morrisonhershfield.com)